

**Location**  
Newport News, VA

**Project Size**  
65,000 SF

**Completion Date**  
Unknown

**Owner**  
Virginia Living  
Museum

**Architect**  
The Potomac Group

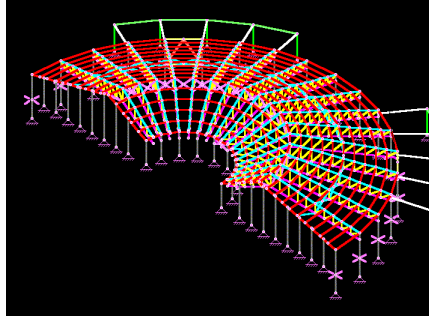

## VIRGINIA LIVING MUSEUM NEWPORT NEWS, VA

A new two-level, 65,000 square foot steel framed museum building. The main building houses several large aquariums as well as traveling and permanent exhibits. Two glass-enclosed habitats house live animals and are accessible from both levels of the building. The primary roof structure was framed with structural steel, scissor trusses laid out on radial grids in a half-circle. A double-helix stair structure is featured in the central, open area. The habitats are framed with steel tube bents. The project also

includes an observatory with roof-top access.

The outdoor portions of the project include a 1000 foot long boardwalk across the lake and overlooking live exhibits, a walk-through aviary, an otter tank and several other structures.